

TELEX®

ENG-100 UHF

WIRELESS MICROPHONE SYSTEM



UHF
668-746 MHz

100
CHANNELS

UP TO
10
SIMULTANEOUS
SYSTEMS

**PORTABLE
RECEIVER**

**HANDHELD
MIC
TRANSMITTER**

**PLUG-ON
MIC
TRANSMITTER**

**BODYPACK
TRANSMITTER**

TELEX®

ENG-100 UHF

WIRELESS MICROPHONE SYSTEM



Key features

- Frequency-agile 100-channel ENG-100 UHF receiver mounts on and interfaces with virtually all professional camcorders.
- Dual integral antennas and Posi-Phase™ diversity assures clear, superior quality, drop-out free audio.
- ENG-100 receiver provides side-mounted controls, XLR mic output, headphone output and internal (two AA batteries) or external power for hassle-free field operation.
- UT-102 universal plug-on transmitter adds any dynamic and most electret condenser mics to the ENG-100 system. Ideal mate for Electro-Voice® RE50—the classic TV reporter's handheld mic.

Clear, accurate sound for news teams on the go.

In TV news and event videography, sound is as important as pictures. The Telex® ENG-100 UHF wireless microphone system captures every critical word with the reliable performance that nonstop news gathering demands. The ENG-100 system fits a wide range of field operations with three different transmitters: handheld mic, plug-on mic, and bodypack. The lightweight, camera-mounted receiver offers 100-channel UHF frequency agility in the 668-746 MHz range, with Posi-Phase™ diversity for clear reception under the most difficult conditions. Whether you're shooting breaking news, a corporate video, or a live event, depend on the ENG-100 to accurately capture the other half of the story: the sound.

SYSTEM CONFIGURATIONS AND COMPONENTS

ENG-100 UT

SYSTEM INCLUDES:

- ENG-100 UHF 100-channel receiver.
- UT-102 plug-on two-channel transmitter.
- SEB-1 single earbud with cord.
- XLR-to-pigtail audio cable.

ENG-100L

SYSTEM INCLUDES:

- ENG-100 UHF 100-channel receiver.
- LT-1000 bodypack transmitter.
- ELM-22S omni-directional lapel microphone.
- SEB-1 single earbud with cord.
- XLR-to-pigtail audio cable.

ENG-100

UHF SYNTHESIZED MIC RECEIVER.

- 100-channel, frequency-agile operation; 668-746 MHz.
- Posi-Phase™ II Smart Diversity reception.
- Posi-Squelch™ III Auto Suppression.
- Tone-code squelch.
- Mounts on most professional camcorders.
- Balanced XLR mic output.
- Headphone monitor jack.
- Operates on two internal AA batteries or external 9-17 VDC source.

LT-1000

UHF SYNTHESIZED BODYPACK TRANSMITTER.

- 100 selectable channels.
- Power on/off.
- TA-4M mic connector.
- Operates on one 9v battery.

SH-1000

UHF SYNTHESIZED HANDHELD MIC TRANSMITTER.

- EV N/D767a dynamic mic.
- 100 selectable channels.
- Power on/off.
- LCD display shows channel frequency, and battery life.
- High/low transmit power output.
- Operates on one 9v battery.

UT-102

UHF CRYSTAL-CONTROLLED PLUG-ON MIC TRANSMITTER.

- Two-channel, frequency agile.
- Separate power on/off and mic mute switches.
- Low battery/overmodulation indicator.
- Rugged metal aircraft alloy case.
- Operates with dynamic or condenser mics; provides +5 VDC power for electret mic elements.
- Operates on one 9-volt battery.

RECEIVER/CAMCORDER MOUNTING OPTIONS

DC-GM

Anton/Bauer™ "Sandwich" Mount.



Mounts ENG-100 between camera and an Anton/Bauer battery. Made with Anton/Bauer supplied parts. Fully compatible with Anton/Bauer Gold Mounts and Digital Gold Mounts.

DC-SM

Anton/Bauer™ Side Mount Plate.



Attaches ENG-100 to Anton/Bauer-brand side mount accessory.

DC-UM

Universal Strap Mount Kit.



Universal mounting device fits virtually any video camera. Adjustable, self-locking Velcro® strap assures a secure mount.

DC-NP1

Standard NP-1/BP-90 Mount Kit.



Allows ENG-100 to be mounted on a standard NP-1 or BP-90 battery holder. Can be easily installed and removed with thumb screws.

Operating Frequencies

TWO STANDARD FREQUENCY OPTIONS

FREQUENCY GROUP "A"

Channels 00-99 686.1-679.5 MHz UHF TV Channels 47-48

FREQUENCY GROUP "B"

Channels 00-99 734.1-745.5 MHz UHF TV Channels 58-59

UT-102 FREQUENCY

ORDER SUFFIX	-A16	-A45	-B20	-B47
ENG-100	GROUP/CHANNEL	GROUP/CHANNEL	GROUP/CHANNEL	GROUP/CHANNEL
	A 16	A 45	B 20	B 47
	A 51	A 79	B 51	B 72

FREQUENCY

CHANNEL 1	670.100	673.100	736.500	739.300
CHANNEL 2	674.200	677.400	740.200	742.700

TV CHANNELS

CHANNEL 1	47	47	58	58
CHANNEL 2	48	48	59	59

Accessories & Parts

ORDER NUMBER	DESCRIPTION
AN-HTB 879220-4	Replacement antenna for ENG-100 receiver Covers 636-725.9 MHz
AN-HTB 879220-5	Replacement antenna for ENG-100 receiver Covers 726-825.9 MHz
MAC-2 63841-002	XLR to TA4 adaptor cord

SPECIFICATIONS

ENG-100 Receiver

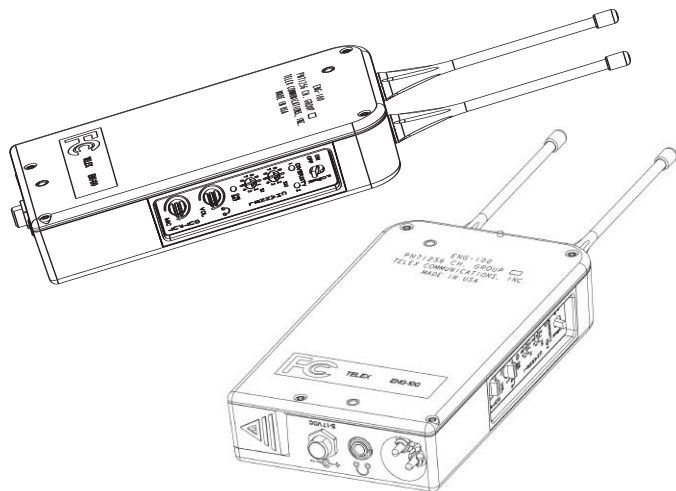

Controls

Mic output level trim, headphone volume, channel selectors, power switch.

Displays/Indicators

On/low battery indicator. Diversity A/B antenna indicators.

Connectors

XLR mic-level balanced output. Headphone jack. External power jack.

Antennas	1/4-wave rubber ducky type antennas
Frequency ranges	668-680 MHz and 734-746 MHz
Number of channels	100 within UHF TV channels 47-48 or 58-59
Diversity technology	Posi-Phase™ phase diversity with two antennas attached
RF stability	0.005% or better
Modulation type	FM, 40 kHz at -3 dB points
Receiver type	Single conversion, 10.7 MHz IF
IF bandwidth	180 kHz at -3 dB points
Image rejection	65 dB or better
Hum and noise	-100 dB
Squelch	Fixed, internal, 31.250 kHz tone + amplitude
Squelch quieting	100 dB
Squelch level	1.5 µV
Receiver sensitivity	Less than 1.0 µV for 12 dB SINAD; 0.7 µV typical
FCC type acceptance	Part 15
Audio specifications	
Frequency response	50-15,000 Hz ±1 dB
Audio output	Mic: -10 to -60 dBV into 200 ohms
Headphone	16-32 ohms
Distortion	Less than 1%
Signal-to-noise ration	110 dB
General specifications	
Dimensions	3"W x 5"H x 1"D
Weight	8 oz.
Input power	2 AA-size alkaline batteries, or 9-17 VDC external
Battery life	6-8 hours (alkaline)
Temperature range	-4°F to +130°F (-20°C to +55°C)

LT-1000 Bodypack Transmitter

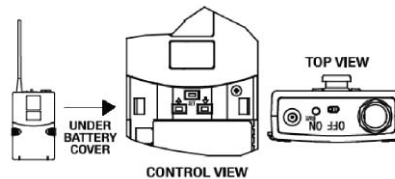

Radiated Output	30 mW typical
Standard Lavalier Microphone	ELM-22S MicroMini™, Omni-Directional Condenser
TA4 Connector Wiring	Pin 1: Ground; Pin 2 Mic Input; Pin 3: +5V bias; Pin 4: +5V bias through a 3k Ohm resistor
Audio Gain Adjustment	40 dB
Power Requirements	9 Volt Alkaline Battery
Battery Life (Typical)	> 8 hours with 9-Volt Alkaline
Bodypack Antenna	Flexible external 1/4 wave
Dimensions (Bodypack)	3.8 in. H x 2.38 in. W x 0.92 in. D 96.5 mm H x 60.5 mm W x 23.4 mm D

SH-1000 Handheld Transmitter

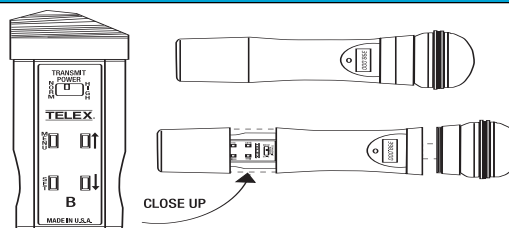

Controls	Power on/off Audio gain adjustment with 26 dB range Transmit power switch Menu, set, up, down buttons
Displays	LCD display (channel and group, frequency, battery level), red LED battery low indicator
Battery Life	8 hours with 9V alkaline (typical)
Antenna	Internal 1/2 wave
Microphone Elements	EV N/D 767a Dynamic, RE 510 Condenser or RE-410 Condenser
RF Output	Normal 5 mW (typical) High 50 mW (typical)
Size	10.5 in. long (26.8 cm)

UT-102 Plug-on Mic Transmitter



Dimensions	3.5"H x 1.5"W x 1.5"D
Weight	8 oz.
Part number	71316-XXX

Number of channels	2
Power output	45 mW typical
Antenna	Internal and attached microphone handle
Microphone	Dynamic or electret, +5 VDC bias
DC power	One 9-volt alkaline battery
Battery life	6-8 hours, alkaline battery
Battery indicator	Red LED lights when battery is low
Overmodulation indicator	Red battery LED flashes with audio overmodulation
Approvals	FCC Part 74H, Industry Canada RSS 123

TELEX COMMUNICATIONS

12000 Portland Avenue South, Burnsville, Minnesota 55337 U.S.A.

TEL: 800-392-3497 • FAX: 952-887-5595

pro.sound@telex.com

www.ElectroVoice.com/Telex-Wireless

SPECIFICATIONS SUBJECT TO CHANGE WITHOUT NOTICE.

©2005 Telex Communications PA-20529A